

Products > Downlight > Downlight 1008.1003

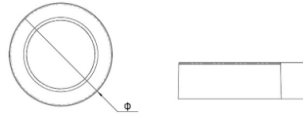

## Downlight 1008.1003

### Line Drawing



### Downloads



### Physical Specification

Code	1008.1003.01	1008.1003.02	1008.1003.03	1008.1003.04
Product Dimensions (mm)	Φ120×H38mm	Φ145×H38mm	Φ170×H38mm	Φ220×H38mm
Finish/Color	White	White	White	White
Material	PC	PC	PC	PC
On/Off Switch	N	N	N	N
Cable Length (m)	12cm	12cm	12cm	12cm
Cable Spec.	H03VVH2-F 2×0.75mm <sup>2</sup>	H03VV-F 2×0.75mm <sup>2</sup>	H03VV-F 2×0.75mm <sup>2</sup>	H03VV-F 2×0.75mm <sup>2</sup>
Plug	N	N	N	N
Terminal Block	N	N	N	N
Installation	Surface mounted	Surface mounted	Surface mounted	Surface mounted
Class	2	2	2	2

### Electrical Characteristics

Total Power Consumption Wattage/On-Mode Power	9	12	18	24
Product Voltage	220-240	220-240	220-240	220-240
Hertz	50/60	50/60	50/60	50/60
IP Rating	IP20 / IP54	IP20 / IP54	IP20 / IP54	IP20 / IP54
Luminous Flux	900	1200	1800	2400
Kelvin	3000K/4000K/6000K	3000K/4000K/6000K	3000K/4000K/6000K	3000K/4000K/6000K
LED Package Type	SMD	SMD	SMD	SMD
Lamp/Bulb Specification (if not LED)	N/A	N/A	N/A	N/A
Lamp/Bulb included?	N/A	N/A	N/A	N/A
SDCM	< 6	< 6	< 6	< 6
CRI	> 80	> 80	> 80	> 80
Power Factor	>0.5	>0.5	>0.5	>0.5
UGR	>19	>19	>19	>19

### Function

Linkable	N	N	N	N
CCT function	Optional	Optional	Optional	Optional
Multi-section Power	N	N	N	N
Dimmable	N	N	N	N
Sensor	N	N	N	N
Emergency	N	N	N	N
Battery Spec.	N/A	N/A	N/A	N/A

Introduction

Research And Development

Technical Department

Graphics Department

Qualification

New arrival

Waterproof

Bulkhead / Flush

Ceiling light

Desk lamp

Battens

Panel / Frame

Downlight

Counter & Cabinet

Work light & Flood light

Email:reon@brightsources.cn

Phone:+86-574-87309279

Fax:+86 574 8730 3683